



**WELCOME BACK - 06<sup>th</sup> February 2021**  
**ESSENTIAL SAFETY INFORMATION PLAN - COVID-19**

# ESSENTIAL SAFETY INFORMATION

---

## **Tickets**

- To keep everyone safe, we are allowing fewer attendees into the church building to enable us to all stay COVID safe. This means that everyone who wants to attend a Sabbath worship service must have ordered a ticket in advance, via Eventbrite.
- You will receive a ticket to present on your phone (this does not have to be printed) and you will need to show this at the entrance to get in.

## **If You Or Someone You Know Is Experiencing Coronavirus Symptoms**

- Please stay home if you are experiencing any symptoms of Covid-19 (these are listed on the NHS website) or if you have recently been in contact with someone who has Covid-19.
- If you are unable to use your tickets because you are unwell, contact the church by ringing: 0117 9243740 or email: [centralsda@gmail.com](mailto:centralsda@gmail.com) to enable someone else to access the service.

# ESSENTIAL SAFETY INFORMATION

---

## Arriving At The Building

- We recommend you arrive as close to 12:00 as possible, there are no areas to wait.
- You may be asked to join a short socially distanced queue before entering.
- Please arrive wearing your mask
- When you arrive at church your ticket will be checked against the register.
- Your temperature will be taken by a greeter, using a non contact thermometer.
- You will be asked to sanitise your hands on entry.
- You will then be directed to a seat. We are asking you to use the plastic chairs, not the padded chairs.
- Families will be seated together
- Our greeters will be able to help you with any questions when you arrive.

# ESSENTIAL SAFETY INFORMATION

---

## **Toilets**

- The toilets will be open for usage, we ask that you wipe as you go.

## **Cloakrooms**

- To reduce face to face contact, we ask you not to gather in the foyer, but take your seat.
- There are no cloakrooms so please do not bring lots of things with you, (there is limited storage space available). Prams, Wheelchairs and buggies are welcome however.

## **Refreshments**

- We will not be providing refreshments after the service.

# ESSENTIAL SAFETY INFORMATION

---

## Following Safety Measures

We want you to feel confident and have the best worship experience when you visit, so we ask you to please:

- follow our one-way system
- allow a safe distance between yourself and other attendees
- use the hand sanitisers around the building
- wear a mask or face covering

Our duty team will be wearing masks whilst on duty, in line with Government guidance on wearing face coverings in places of worship, we are asking all attendees to do so too.

To help with social distancing and to allow everyone to move around the building with confidence, you may be asked to keep moving if you stop to wait or gather.

Please do everything you can to help keep everyone safe by following these measures. It is possible our duty team may ask attendees who do not, to leave.

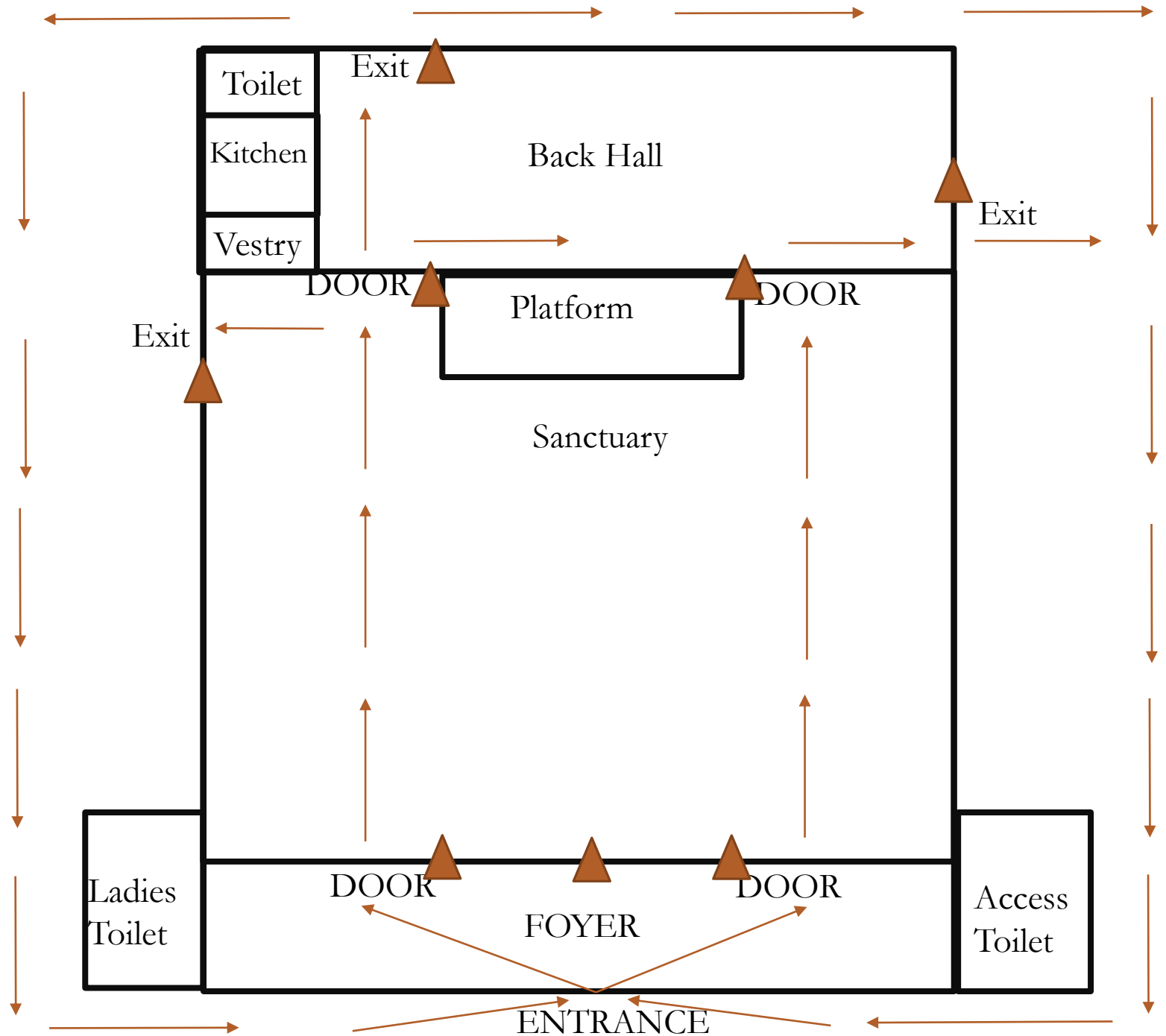

▲  
Sanitiser Point









# ESSENTIAL SAFETY INFORMATION

---

## What We're Doing to Keep People Safe

As we welcome you back, our number one priority is your health and wellbeing. We have introduced a number of measures across the building to help everyone remain safe while they are here. We are following the official Working Safety during Covid-19 Government guidance to make sure the whole building is Covid secure. Measures we have introduced so far include:

- Reduced numbers of attendees
- Clear signage to guide people safely around the building
- Removal of seating and changes to how you access toilets to ensure social distancing
- Hand sanitiser stations at all entrances
- Weekly deep and thorough cleaning of door handles, rails, toilets and other areas
- Asking everyone to wear face coverings while in the building

We will continue to review and manage any risks and to respond to any changes in Government guidance, keeping our duty team trained and up to date as we go

# DUTY TEAM

---

- DUTY LEADS: Kwasi, Janet, Sharon, Mary, Neciah, Albert
- MUSIC LEADS: Sharon, Michael S, Mary, Martha, Albert
- GREETERS: Michael S, Michael B, Burnet, Norda, Albert
- TREASURY: Victoria, Kwasi
- AV/MEDIA: Neciah, Princess, Mary, Marie
- FIRST AID: Sharon, Mary, Martha, Albert

# DUTY TEAM



# ORDER OF SERVICE

---

**Worship:** The plan is to go live via Zoom at 12noon or directly after the Health and Community spot

- **PERSON A** Welcome/Announcements/Prayer
- **PERSON B** Sing a long/Opening Hymn
- **PERSON C** Pastoral Prayer
- **PERSON C** Scripture Reading
- **PERSON B** Meditational
- **PERSON D** Sermon
- **PERSON B** Closing Song
- **PERSON D** Closing Prayer
- **NB:** Offering will be collected on exiting the building, Victoria (YES).





# Tithes & OFFERING



SEE CHURCH  
AND OR SEC  
WEBSITE FOR  
PAYMENT  
OPTIONS



SEC WEBSITE /  
BANK TRANSFER /  
STANDING ORDER



CHEQUE /  
TELEPHONE



TEXT GIVING



MOBICASH APP

**WE**

**TO**

**CAN'T**

**SEE**

**YOU**



Sister Veronica

ALBERT

Ingrid

Pat

Pauline

Mark

Shaun

The Browns

Florence

Sindi Mabena

Gordon's

Janet

Norda

Maria

nana's family

Debbie

Dankwa Family

Stacy

Pauline

Kim

**GOD**

**IS**

**IN**

**CONTROL**

Bonqiwe

Marco Francis



**WE LOOK FORWARD TO WELCOMING YOU**

**06<sup>th</sup> February 2021**

**ESSENTIAL SAFETY INFORMATION - COVID-19**